

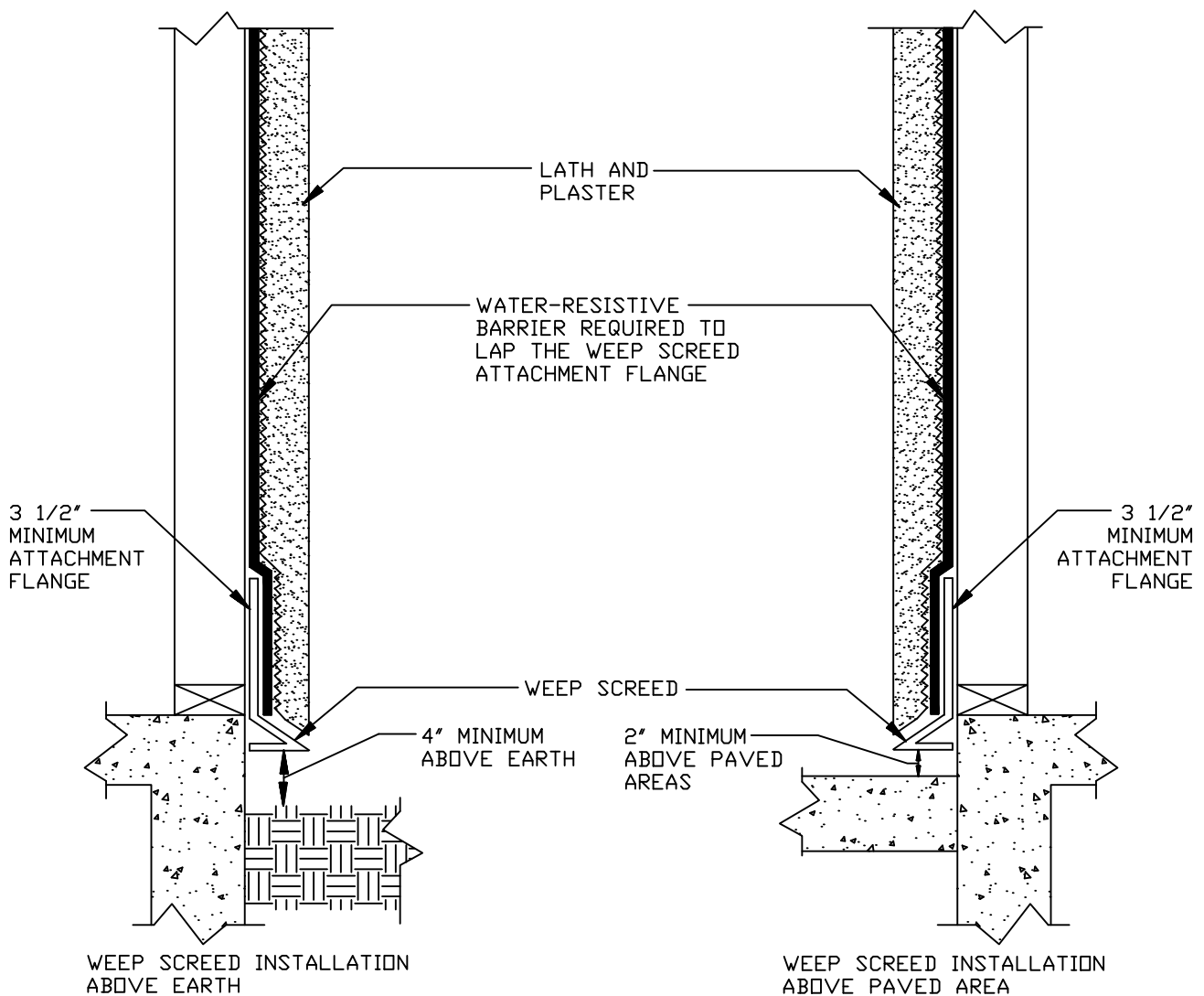

WEEP SCREED DETAIL

NOTE: THIS DETAIL IS IN ACCORDANCE WITH THE 2007 EDITION OF THE CALIFORNIA BUILDING CODE SECTION 2512.1.2.



* A MINIMUM 0.019 INCH (NO. 26 GALVANIZED SHEET GAUGE) CORROSION-RESISTANT WEEP SCREED WITH A MINIMUM VERTICAL ATTACHMENT FLANGE OF 3 1/2" SHALL BE PROVIDED AT OR BELOW THE FOUNDATION PLATE LINE ON ALL EXTERIOR STUD WALLS. THE SCREED SHALL BE PLACED A MINIMUM OF 4" ABOVE THE EARTH OR 2" ABOVE PAVED AREAS AND SHALL BE OF A TYPE THAT WILL ALLOW TRAPPED WATER TO DRAIN TO THE EXTERIOR OF THE BUILDING. THE WATER-RESISTIVE BARRIER SHALL LAP THE ATTACHMENT FLANGE AND THE EXTERIOR LATH SHALL COVER AND TERMINATE ON THE ATTACHMENT FLANGE OF THE SCREED.